

1H Series

Miniature Surface Mount

PRODUCT DESCRIPTIONS

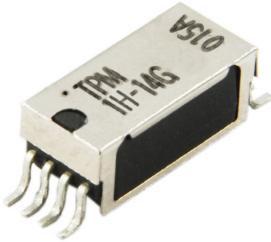

As a standard for Sanyu SMT relays, the 1H Series has been widely accepted by the ATE, telecommunications, and instrument markets. A variety of package styles such as Gull-Wing, J-Lead and Axial are produced to best suit your application needs.

- RF Performance up to 4GHz
- Impedance 50Ω
- UL Certified

SPECIFICATIONS



| 1H Series | | 1H-54G | 1H-14G | 1H-24G | |
|--|------------------------|------------------|--|--------|--|
| | | 1H-54J | 1H-14J | 1H-24J | |
| | | 1H-54A | 1H-14A | 1H-24A | |
| Parameters | Units | 1 Form A | | | Test Conditions |
| Coil Specifications | | | | | |
| Nominal Coil Voltage | VDC | 3.3 | 5.0 | 12.0 | ±10% @ 20°C @ 20°C @ 20°C |
| Coil Resistance | Ω | 80 | 150 | 500 | |
| Operate Voltage | VDC Max | 2.8 | 3.75 | 8.8 | |
| Release Voltage | VDC Min | 0.5 | 0.7 | 1.2 | |
| Contact Ratings | | | | | |
| Switching Voltage | Volts | 100 | | | Max DC/Peak AC resistance Max DC/Peak AC resistance Max DC/Peak AC resistance(@ 30°C) Max DC/Peak AC resistance @ 1V 10mA Max initial @ operate voltage Max initial @ operate voltage |
| Switching Current | Amps | 0.5 | | | |
| Carry Current | Amps | 1.0 | | | |
| Contact Rating | Watts | 10 | | | |
| Life Expectancy | x10 ⁶ Cycle | 300 | | | |
| Contact Resistance | mΩ | 150 | | | |
| Contact Resistance Stability | mΩ | 5.0 | | | |
| Relay Specifications | | | | | |
| Insulation Resistance | Ω Min | 10 ¹² | | | Between all isolated pins @ 100V 20°C 65%RH |
| Dielectric Strength (Static) | VDC Min | 200 | | | Between contacts Contacts to shield Contacts/Shield to coil |
| | VDC Min | 1500 | | | |
| | VDC Min | 1500 | | | |
| Operate Time (Including Bounce) | msec Max | 0.3 | | | @ nominal coil voltage 100 Hz square wave |
| Release Time | msec Max | 0.05 | | | Diode suppression |
| Measurement Reference Conditions | | | Environmental Ratings | | |
| Temp: 15°C to 35°C Humidity: 25% to 75%RH Atmospheric Pressure: 860 to 1060hpa | | | Storage temp: -40°C to +85°C Operate temp: -20°C to +80°C Vibration: 20G's to 2000Hz Shock: 50G's Processing temp: 260°C max for 60sec. dwell time | | |

Dimensions All Dimensions are mm (inch)

Land Pattern Recommendation

1H-54G/1H-14G/1H-24G

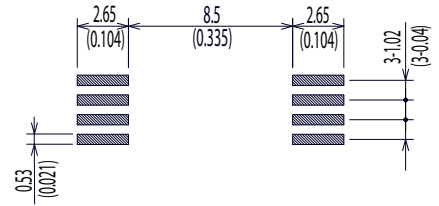
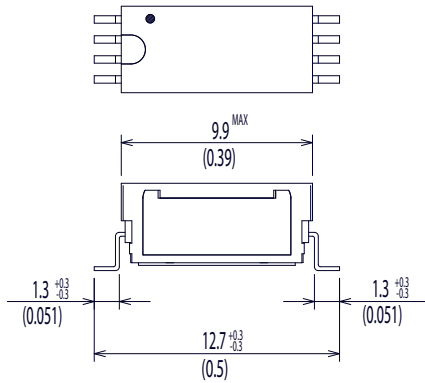

1H-54J/1H-14J/1H-24J

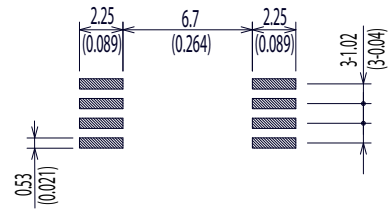
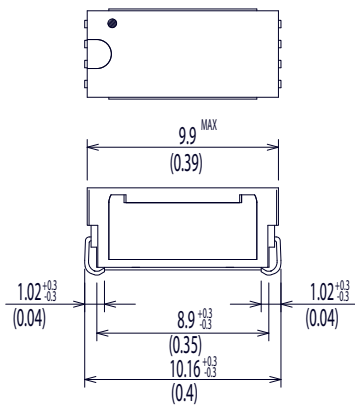

1H-54A/1H-14A/1H-24A

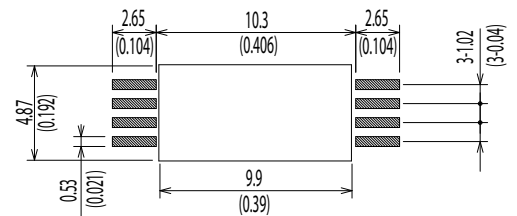
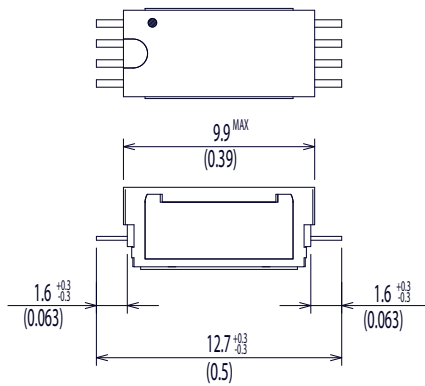

Schematic <Top View>

